

0	GG-C	15-05-2025	-						
A	GG-C	23-06-2025	Added "approx." to date of filter orientation						
REV.	BY	DATE	DESCRIPTION						
TOLERANCES UNLESS OTHERWISE STATED:				COLOR:	SIZE:	STATUS:	ART. NO.:	DIMENSIONS: MM [INCH]	
					A2	Released			
PROJECT:				Exploded views CF500 SLC			MATERIAL:		
DESCRIPTION:				Assembly drawing			SCALE: 1:7 SHEET: 1/1		
							DRAWN: HO DR. DATE: 12-10-2012		
							APR. BY: ES APR. DATE: 23-06-2025		
							TREATMENT: NONE		
							CATEGORY: SYSTEEM		
							DRAWING NUMBER: EV50000-CF-221		
							DEBURR SHARP EDGES WEIGHT:		
							PROJECTION:		
							Byte 14 NL-7741 MK Coevorden Phone : +31-524-593900 E-mail : info@cargofloor.com		
THIS DRAWING IS THE PROPERTY OF CARGO FLOOR B.V. AND MUST NOT BE COPIED OR REPRODUCED WITHOUT THEIR WRITTEN AUTHORITY (ISO 16016:2016)									

FOR INFORMATION ONLY!

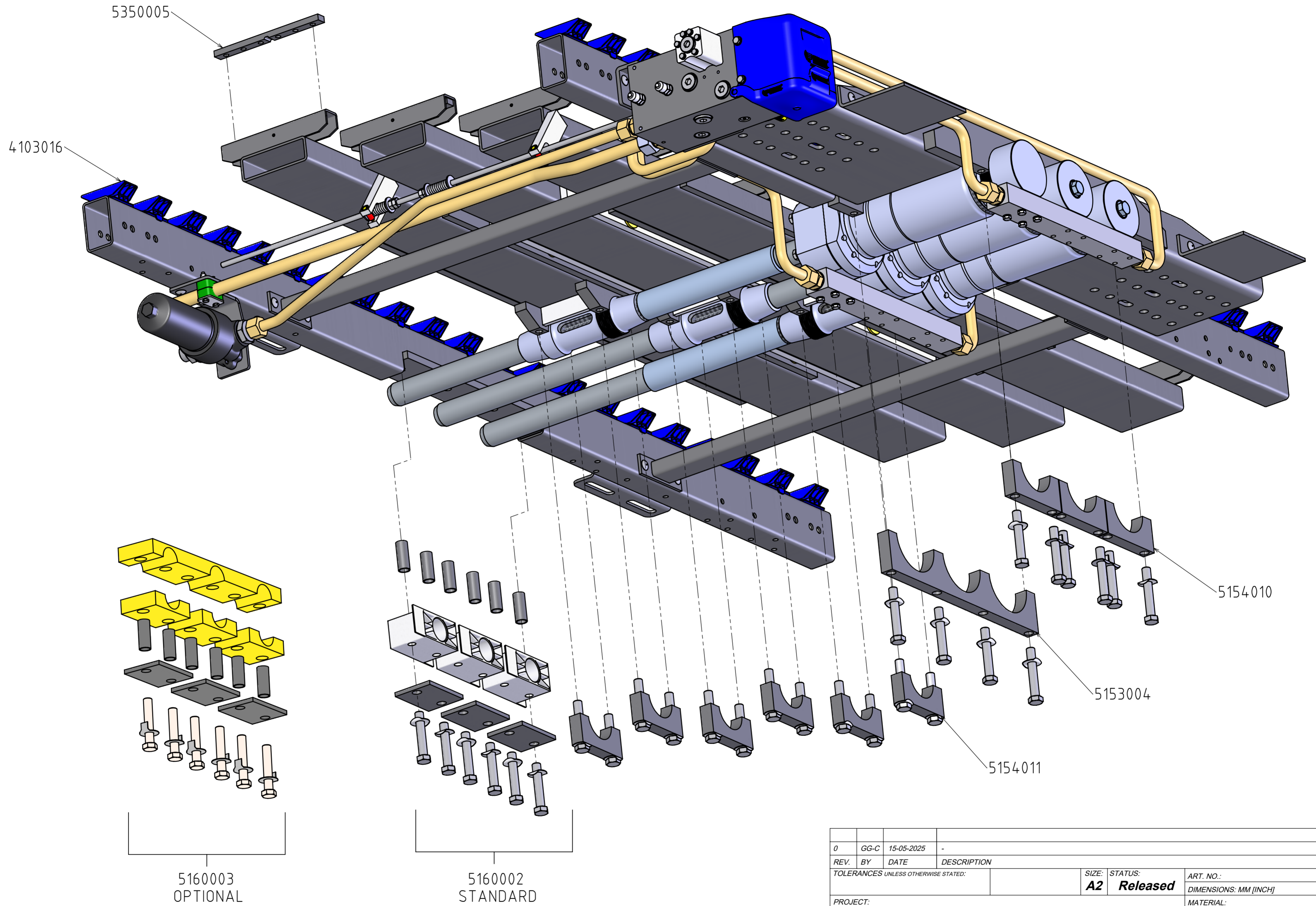

5160003
OPTIONAL

5160002
STANDARD

0	GG-C	15-05-2025	-					
REV.	BY	DATE	DESCRIPTION	SIZE:	STATUS:	ART. NO.:		
TOLERANCES UNLESS OTHERWISE STATED:						A2	Released	DIMENSIONS: MM [INCH]
PROJECT:						MATERIAL:		
Exploded views CF500 SLC						SCALE:	-	SHEET: 1/1
DESCRIPTION:						DRAWN:	HO	DR. DATE: 7-12-2021
Pistonrod guidance & cylinder clamps						APR. BY:	HO	APR. DATE: 15-05-2025
						TREATMENT:	NONE	
						CATEGORY:	SYSTEM	
						PROJECTION:	DRAWING NUMBER:	
							EV50000-CF-222	
						DEBURR SHARP EDGES	WEIGHT:	



Byte 14
NL-7741 MK Coevorden
Phone : +31-524-593900
E-mail : info@cargo-floor.com

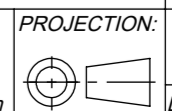

FOR INFORMATION ONLY!

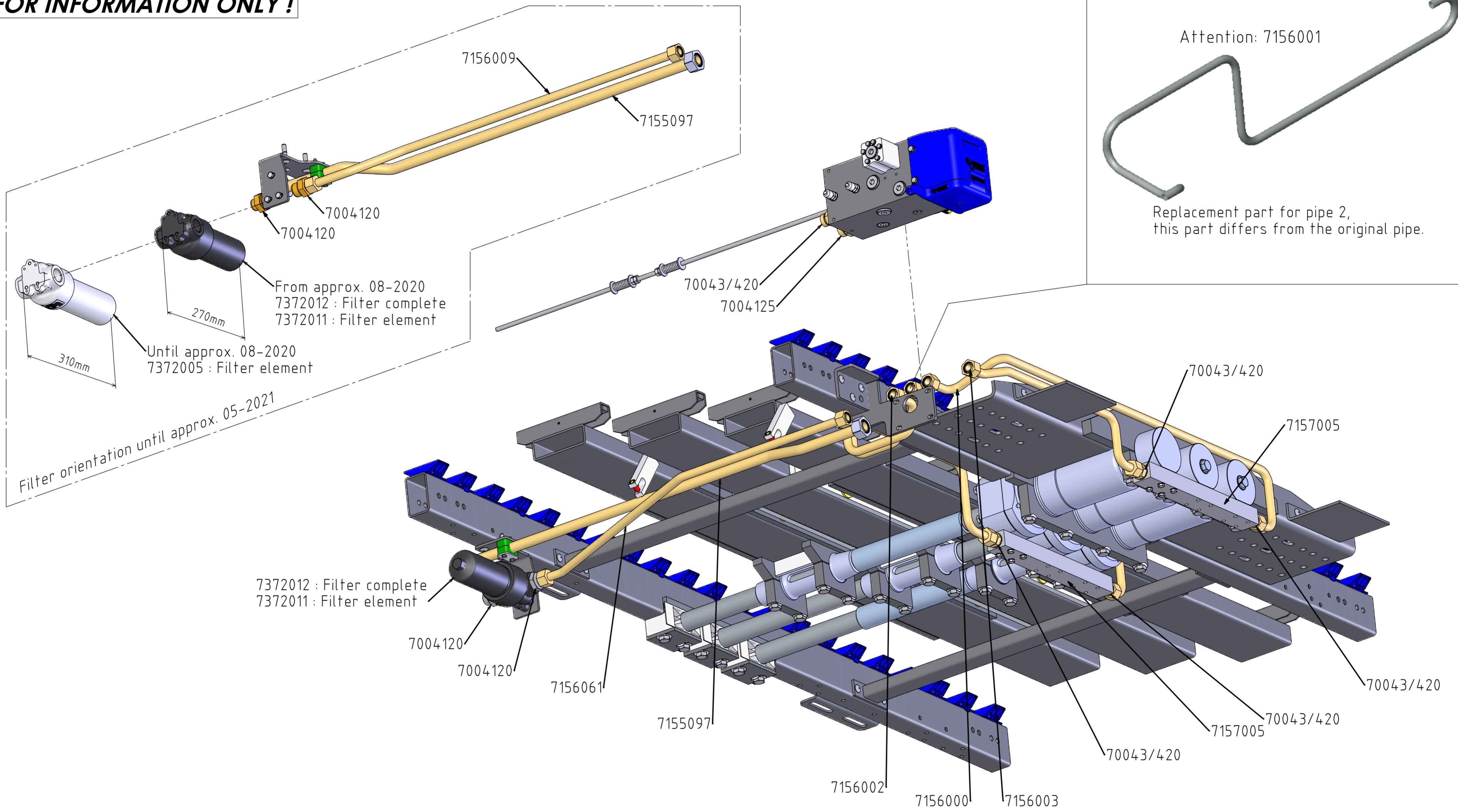

Attention: 7156001

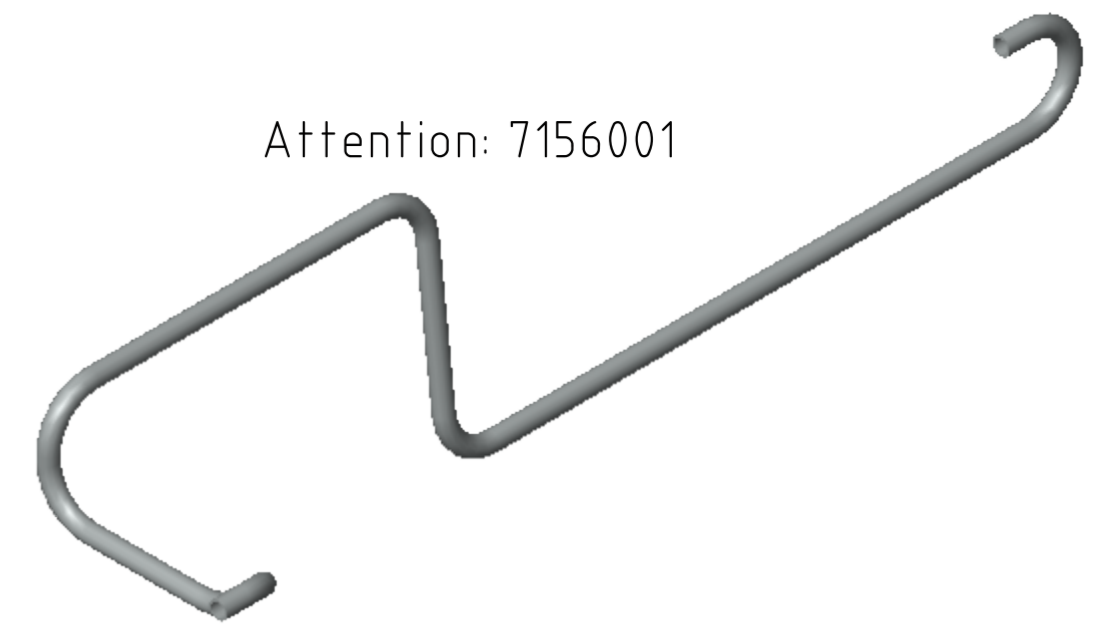

Replacement part for pipe 2, this part differs from the original pipe.

7372012 : Filter complete
7372011 : Filter element

Until approx. 08-2020
7372005 : Filter element

From approx. 08-2020
7372012 : Filter complete
7372011 : Filter element

Filter orientation until approx. 05-2021

0	GG-C	15-05-2025	-
A	GG-C	23-06-2025	Added "approx." to date of filter type and orientation.
REV.	BY	DATE	DESCRIPTION
TOLERANCES UNLESS OTHERWISE STATED:			
			SIZE: A2 STATUS: Released
PROJECT:			ART. NO.:
Exploded views CF500 SLC			DIMENSIONS: MM [INCH]
DESCRIPTION:			MATERIAL:
Piping & filter			SCALE: - SHEET: 1/1
DRAWN: HO DR. DATE: 7-12-2021			APR. BY: ES APR. DATE: 23-06-2025
TREATMENT: NONE			CATEGORY: SYSTEM
DRAWING NUMBER: EV50000-CF-223			DEBURR SHARP EDGES WEIGHT: -
		PROJECTION:	Byte 14 NL-7741 MK Coevorden Phone : +31-524-593900 E-mail : info@cargo-floor.com
THIS DRAWING IS THE PROPERTY OF CARGO FLOOR B.V. AND MUST NOT BE COPIED OR REPRODUCED WITHOUT THEIR WRITTEN AUTHORITY (ISO 16016:2016)			

FOR INFORMATION ONLY !

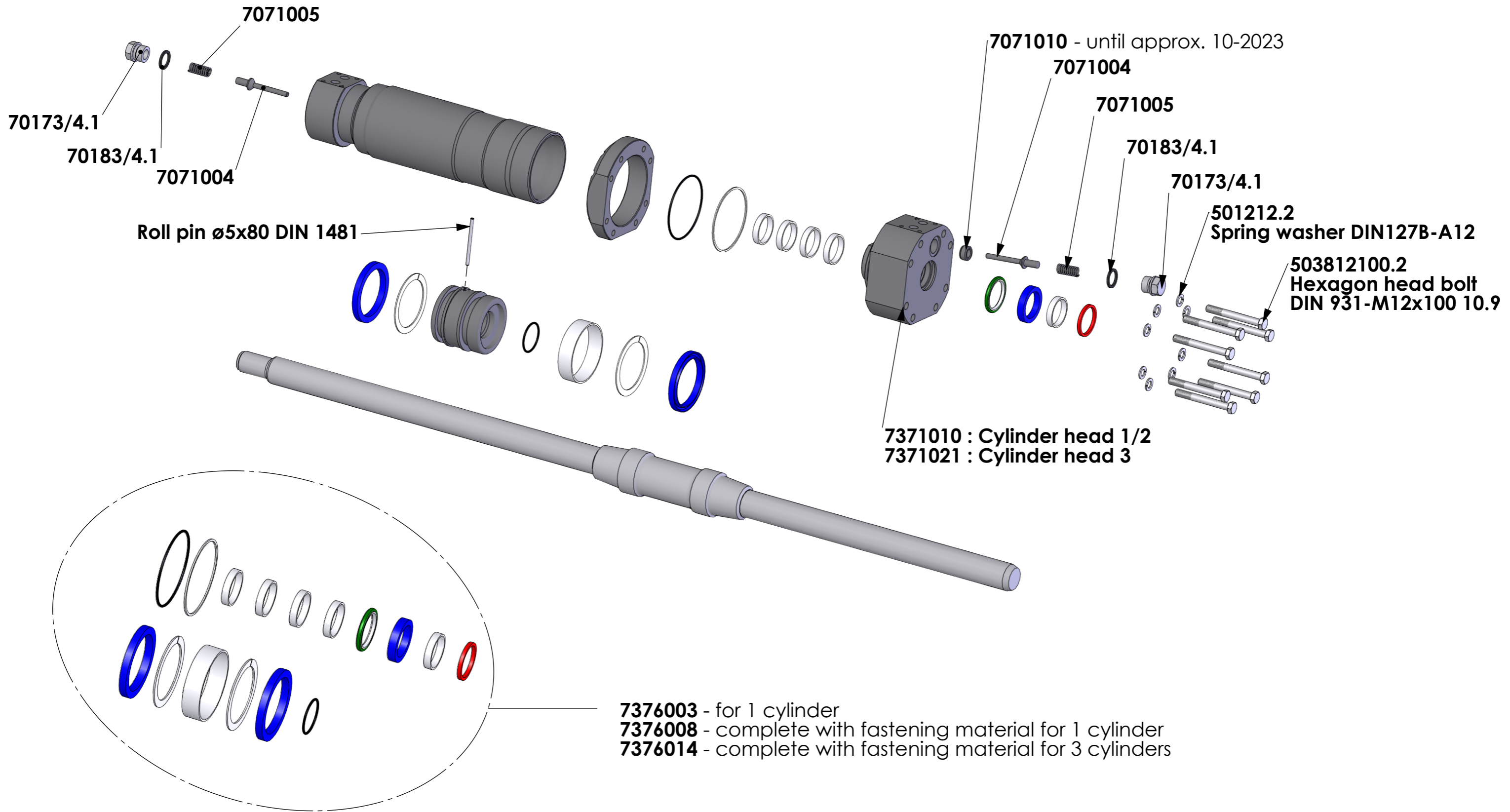

FOR INFORMATION ONLY !

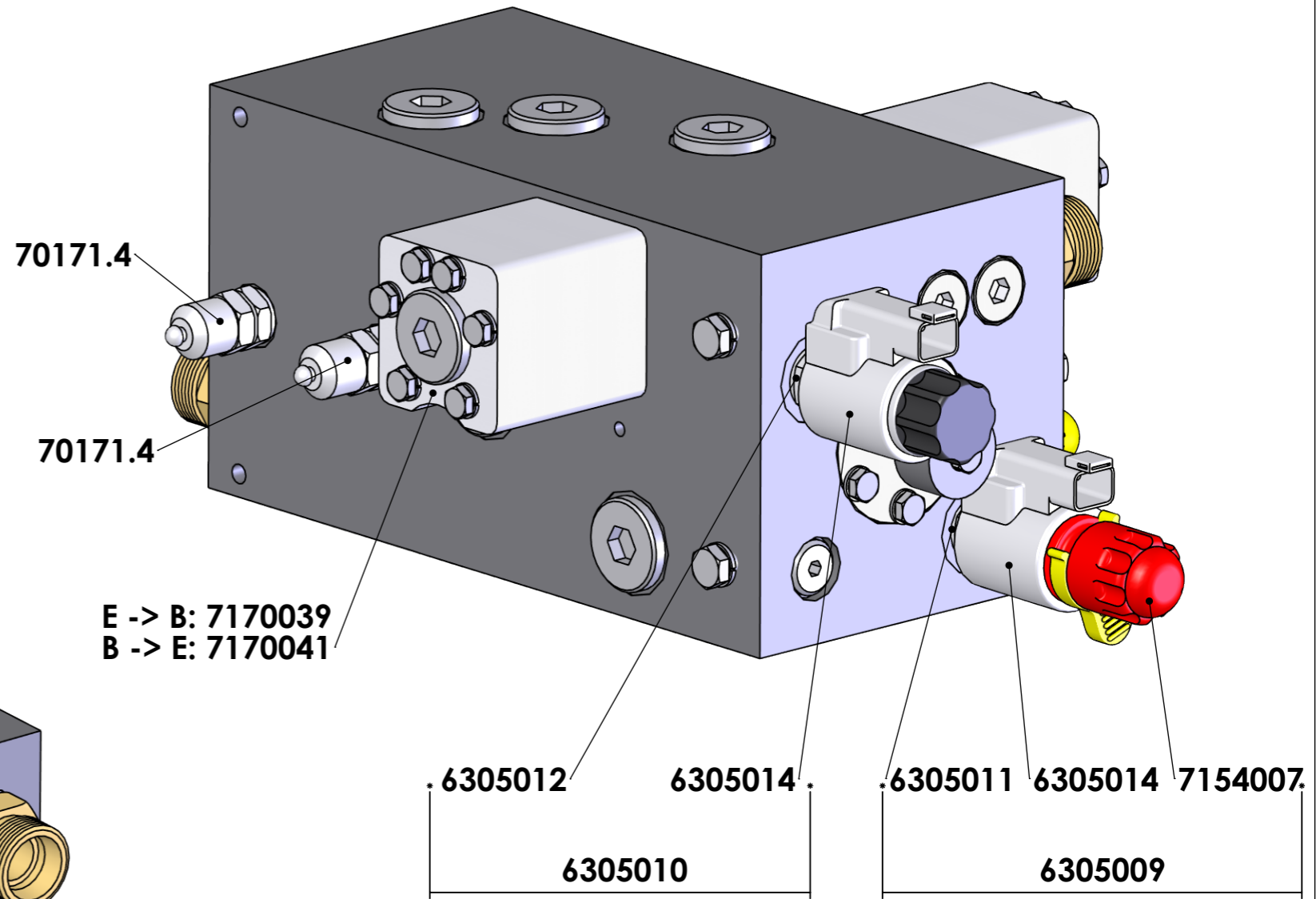
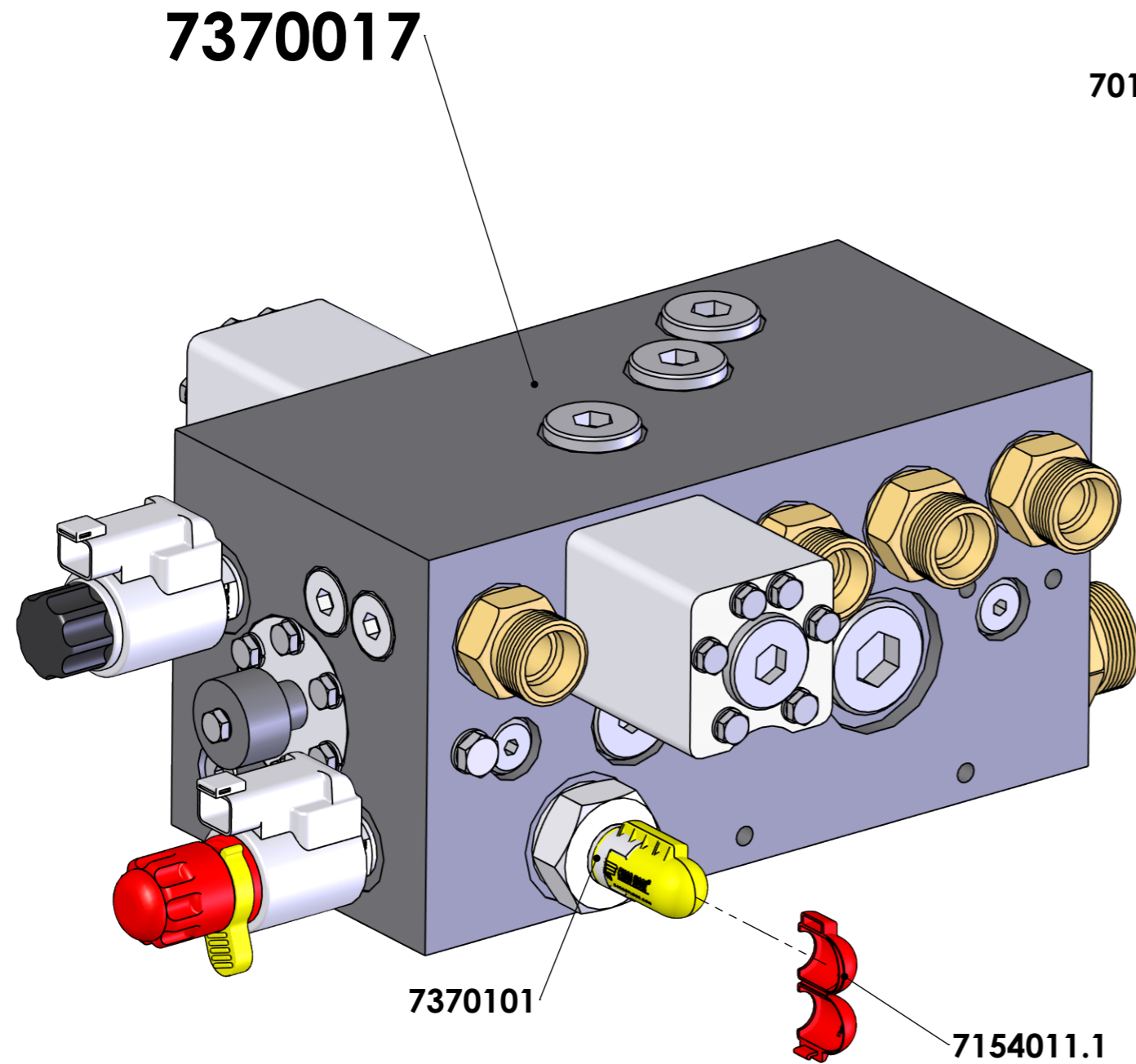

FOR INFORMATION ONLY !

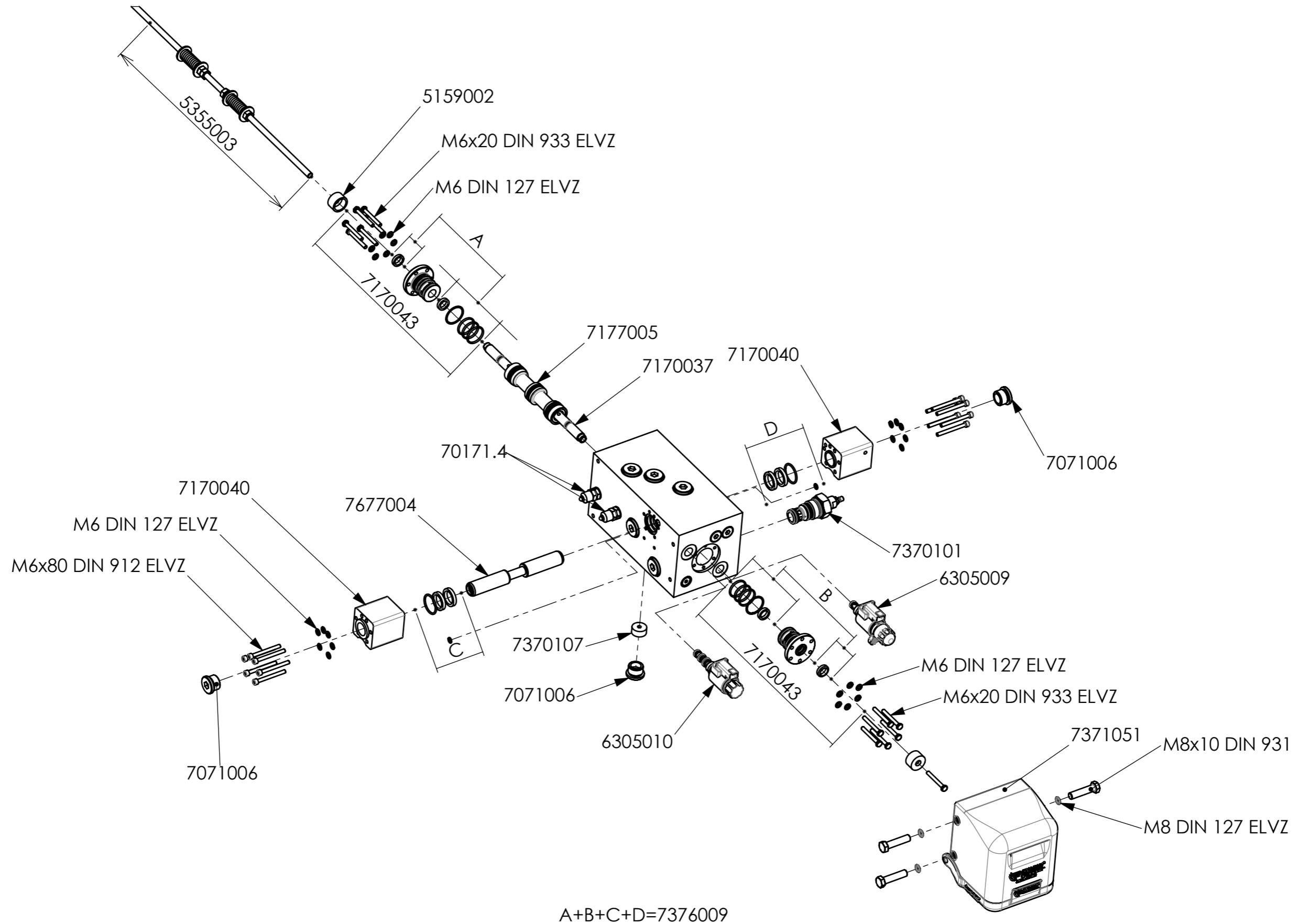

FOR INFORMATION ONLY!

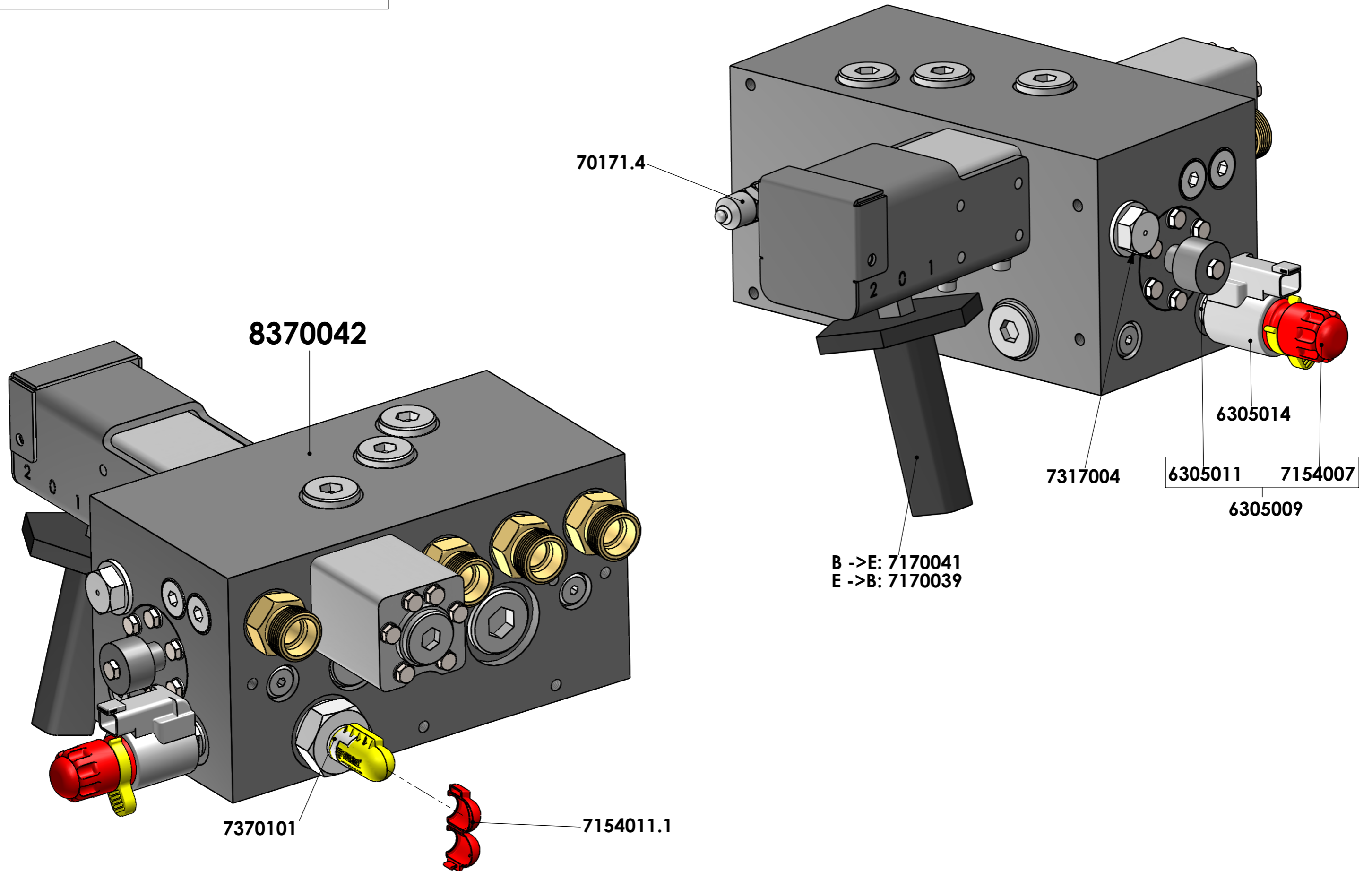

FOR INFORMATION ONLY!

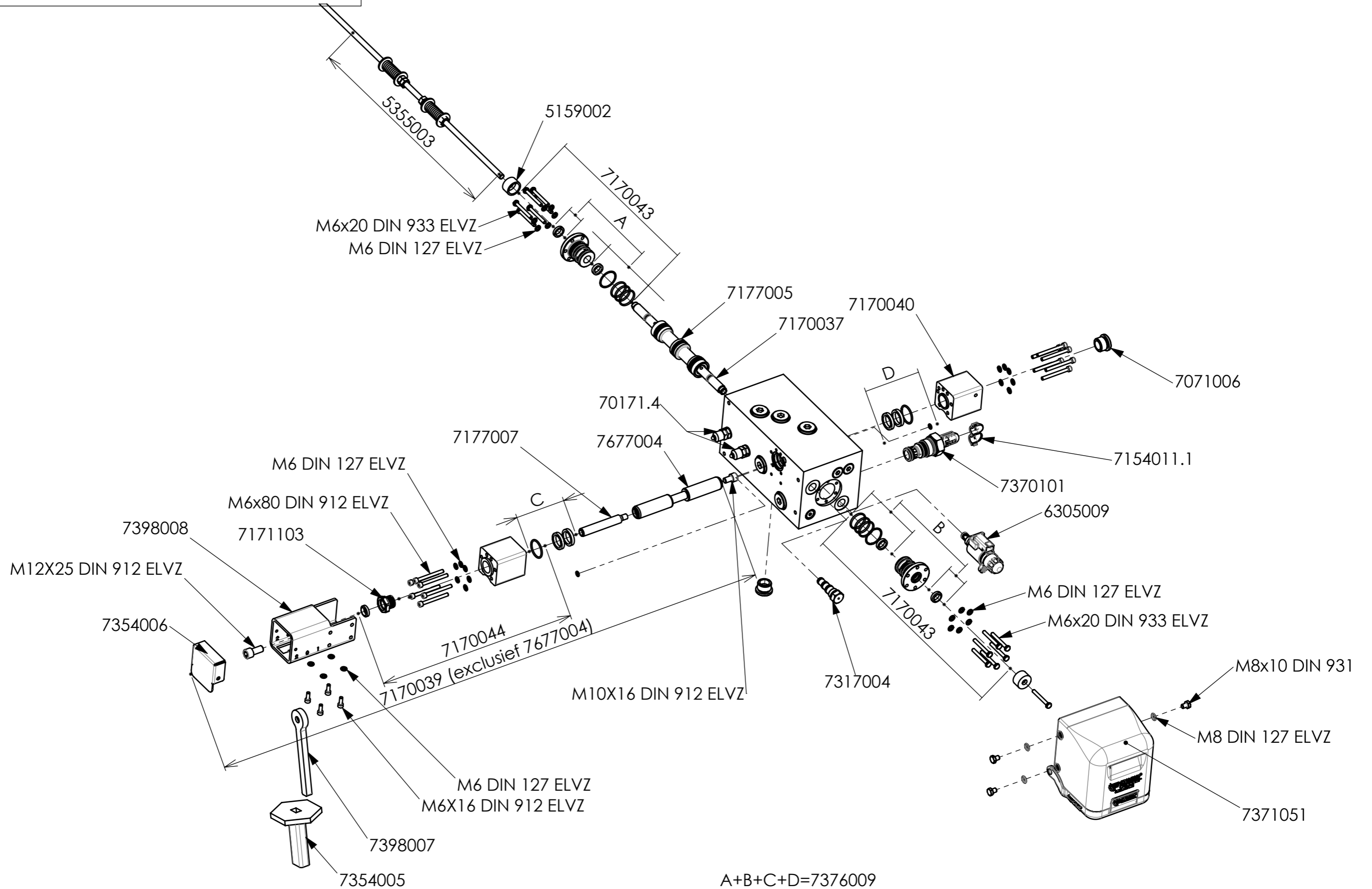

FOR INFORMATION ONLY !

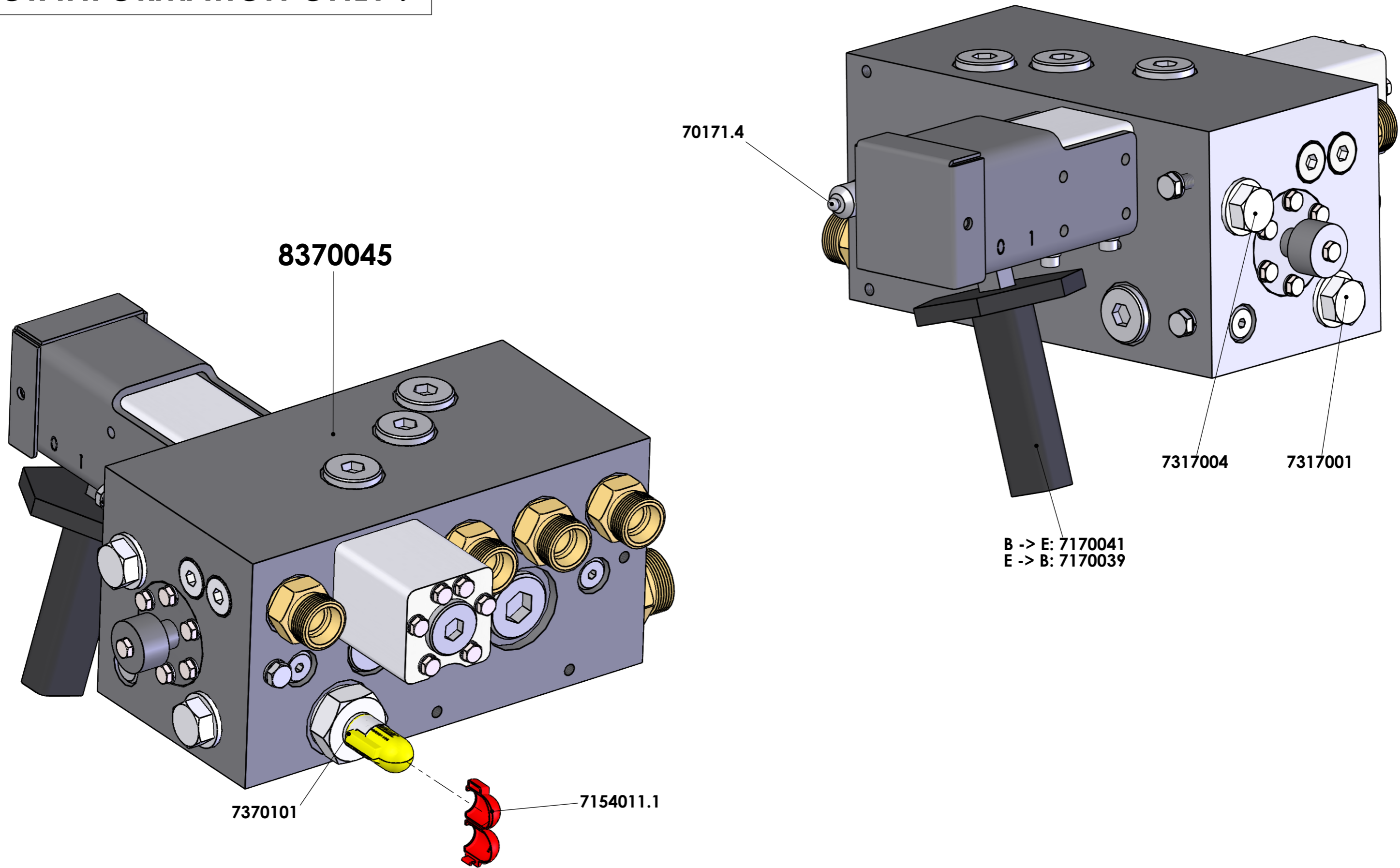

FOR INFORMATION ONLY!

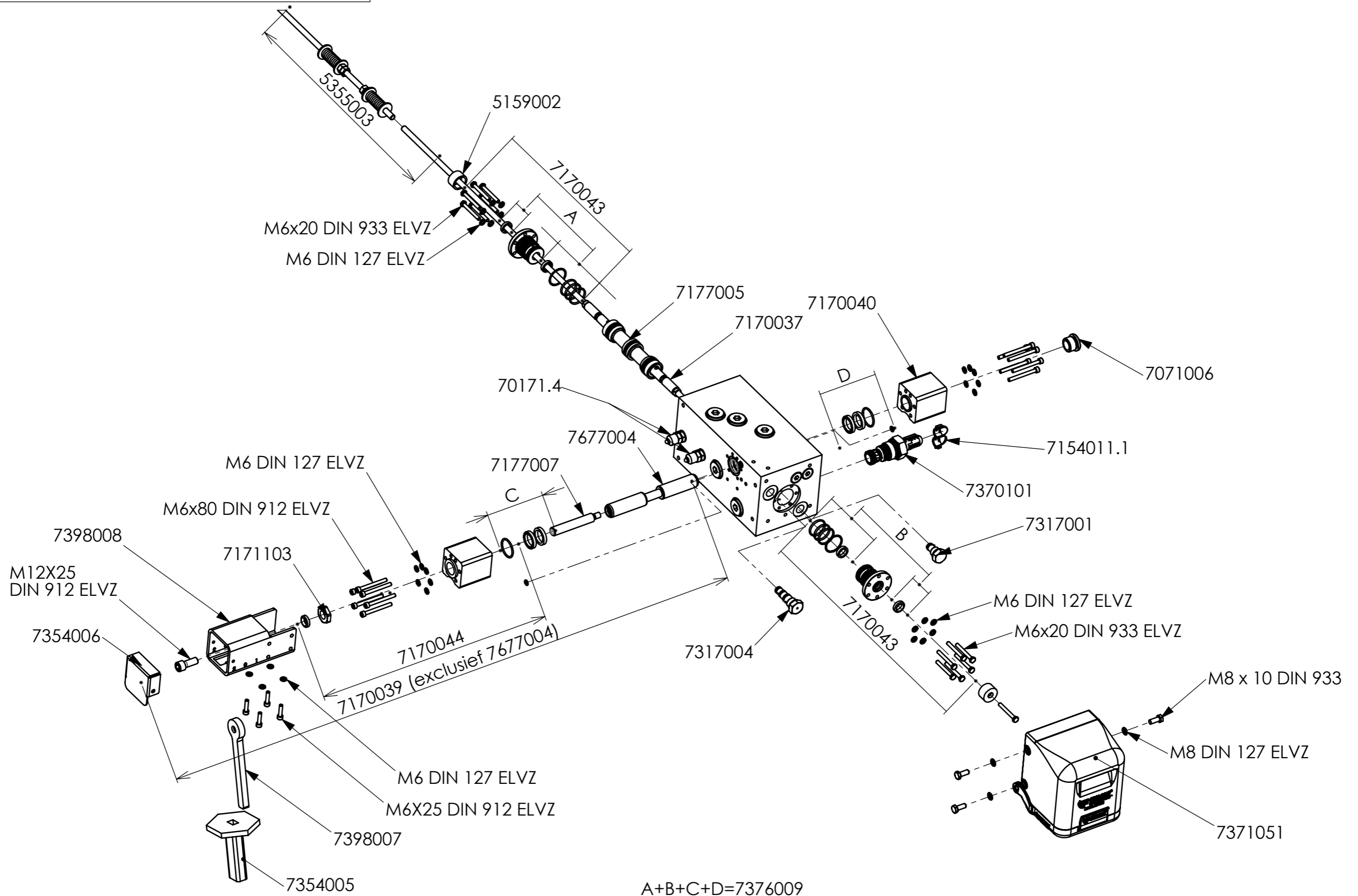

CARGO FLOOR - EXPLODED VIEWS CF500 SLC

8-7-2025

#	BENAMING	DESCRIPTION
4103010	Kunststofkam 7/112 H32mm (wit)	Plastic bearing strip 7/112 height 32 mm (white)
4103016	Kunststofkam kick down 7/112 H32 (blauw)	Plastic bearing comb kick down 7/112 [4.4"] H.32 [1.26"] (blue)
5153004	Klembeugel (3-voudig) compleet	Clamping plate (triple), complete
5154010	Klembeugel cilinder (ø94mm) compleet	Clamping plate for cylinder (ø94mm [3.7"]) complete
5154011	Klembeugel cilindermof (ø74mm) compleet	Clamping plate for cylinder sleeve (ø74mm [2.91"]) complete
5159002	Afstandsring rond 30 mm (omschakelventiel)	Distance ring round 30 mm [1.18"] (switching valve)
5160002	Cilinderstangeleidingsset compleet (CF300 / CF500)	Set Guide blocks for 3 piston rods complete (CF300 / CF500)
5160003	Cilinderstangeleidingsset CF300/CF500/CF600 compleet, massieve uitvoering	Set guide blocks for 3 piston rods CF300/CF500/CF600 complete, solid execution
5350005	Montagestrip (6x M12/240 mm)	Assembly strip (6x M12/240 mm [9.54"])
6305009	Magneet + stift 24V Cargo Floor (GS02) (inc. rode noodbediening)	Cartridge + solenoid 24 V. Cargo Floor (GS02) (incl. red emergency control)
6305010	Magneet + stift 24V Cargo Floor (G02)	Cartridge + solenoid 24 V. Cargo Floor (G02)
6305011	Stift Cargo Floor (GS02)	Cartridge Cargo Floor (GS02)
6305012	Stift Cargo Floor (G02)	Cartridge Cargo Floor (G02)
6305014	Magneet Cargo Floor G(+GS)02 24V	Solenoid Cargo Floor G(+GS)02 24V
7004120	Rechte inschroefkoppeling 1" x 20 mm	Straight screw-in coupling 1" x 20 mm [0.79"]
7004125	Rechte inschroefkoppeling 1" x 25 mm	Straight screw-in coupling 1" x 25 mm [0.98"]
7071004	Volgorde cilinder klep	Poppet valve (sequence cylinder valve)
7071005	Veer voor volgorde cilinder klep (standaard, L.=45 mm)	Spring for sequence cylinder valve (standard, L.=45 mm [1.77"])
7071006	Inbus kraagplug 3/4 incl. dichting	socket plug 3/4" with O-ring
7071010	Volgorde cilinder klepzetting (voldraad)	Order sequence cylinder valve (full thread)
7154007	Kunststof noodhandbediening GS02	Plastic emergency manual control GS02
7155097	Hydraulische leiding nr. 6 (besturingsventiel 02/SLC)	Hydraulic pipe no. 6 (control valve 02/SLC)
7156000	Hydraulische leiding nr. 1 (besturingsventiel 02) compleet	Hydraulic pipe no. 1 (control valve 02) complete
7156001	Hydraulische leiding nr. 2 (besturingsventiel 02) compleet	Hydraulic pipe no. 2 (control valve 02) complete
7156002	Hydraulische leiding nr. 3 (besturingsventiel 02) compleet	Hydraulic pipe no. 3 (control valve 02) complete
7156003	Hydraulische leiding nr. 4 (besturingsventiel 02) compleet	Hydraulic pipe no. 4 (control valve 02) complete
7156009	Hydraulische leiding nr. 5 (besturingsventiel 02) compleet	Hydraulic pipe no. 5 (control valve 02) complete
7156061	Hydraulische leiding 5 (besturingsventiel 02), gedraaid filter	Hydraulic pipe no. 1 (control valve 02), rotated filter
7157005	Common rail A compleet	Common rail A complete
7170037	Voorstuur omschakelplunjer L.= 306 mm. / D.= 16 mm compleet	Pre-steering switching plunger L.= 306 mm. [12"] / D.= 16 mm. [0.6"] complete
7170039	Ombouwset besturingsventiel E->B inclusief arretering	Modification kit control valve E->B including detent
7170040	Deksel Bedienplunjer besturingsventiel 02 compleet	Head for operation plunger housing control valve 02 complete
7170041	Ombouwset besturingsventiel B->E	Modification kit control valve B->E
7170043	Deksel Omschakelplunjer besturingsventiel 02 compleet	Cover for switching piston control valve 02 complete
7170044	Deksel bedienplunjer besturingsventiel 02 (arretering) compleet	Head for operation plunger housing control valve 02 (detent) complete
7171103	Bronzen bus (B-bediening) incl. afstrijker	Bronze bush (B-operation)
7177005	Plunjer omschakel L.= 146 mm / D.= 35 mm compleet	Switching plunger L.=146 mm. [5.7"] / D.= 35 mm. [1.4"] complete
7177007	Koppelstang B-bediening ø16 (M10/M12) compleet	Connection rod B-operation ø16 [0.6"] (M10/M12) complete
7317001	A-plug	Plug A
7317004	Plug G02 t.b.v. B-bediening	Plug G02 for B-control
7354005	Handvat (rubber)	Handle (rubber)
7354006	Stalen dop 70x70 mm	Steel cap 70x70 mm [2.8 x 2.8"]
7370017	Besturingsventiel 02 E-bediend (compleet)	Control valve 02 E-operation (complete)
7370101	Drukstift drukbegrenzingsventiel	Pressure cartridge pressure control valve
7370107	Drossel ø6.5 mm (besturingsventiel 02)	Choke ø6.5 mm (control valve 02)
7371010	Cilinderdeksel nr.1 / 2 (alu.) incl. afdichtingen en klep	Cylinder head no. 1 / 2 (alu.) incl. seals and valve
7371021	Cilinderdeksel nr. 3 (alu.) incl. afdichtingen	Cylinder head no. 3 (alu.) incl. seals
7371029	Hydraulische cilinder CF500 SL-C nr. 1 inclusief bevestigingsmateriaal. Belangrijk: doe	Hydraulic cylinder CF500 SL-C no. 1 with fasteningmaterials. Important: first perform a
7371030	Hydraulische cilinder CF500 SL-C nr. 2 inclusief bevestigingsmateriaal. Belangrijk: doe	Hydraulic cylinder CF500 SL-C no. 2 with fasteningmaterials. Important: first perform a
7371031	Hydraulische cilinder CF500 SL-C nr. 3 inclusief bevestigingsmateriaal. Belangrijk: doe	Hydraulic cylinder CF500 SL-C no. 3 with fasteningmaterials. <A

7371044	Hydraulische cilinder CF500 SL-C nr. 1 HD inclusief bevestigingsmateriaal. Belangrijk:	Hydraulic cylinder CF500 SLC no. 1 HD with fasteningmaterials. Important: first perform a	
7371045	Hydraulische cilinder CF500 SL-C nr. 2 HD inclusief bevestigingsmateriaal. Belangrijk:	Hydraulic cylinder CF500 SLC no. 2 HD with fasteningmaterials. Important: first perform a	
7371046	Hydraulische cilinder CF500 SL-C nr. 3 HD inclusief bevestigingsmateriaal. Belangrijk:	Hydraulic cylinder CF500 SLC no. 3 HD with fasteningmaterials. Important: first perform a	
7371051	Beschermkap besturingsventiel 02 (compleet)	Cover for control valve 02 (complete)	
7372005	CF persfilterelement (04/2005 - 08/2020)	CF Pressure filter element (04/2005 - 08/2020)	
7372011	CF persfilterelement QP (08/2020 - ...)	CF Pressure filter element QP (08/2020 - ...)	
7372012	CF persfilterset compleet QP (08/2020 - ...)	CF Pressure filterset complete QP (08/2020 - ...)	
7376003	Afdichtingset cilinder (CF500)	Seals for cylinder (CF500)	
7376008	Afdichtingsset voor 1 cilinder (CF500SL - SL-2 & SLC) - deze set bestaat uit: Afdichtingset	Seal set for 1 cylinder (CF500SL, SL-2 & SLC), this set consist of: 1 x seals for cylinder	
7376009	Afdichtingset besturingsventiel 02 compleet	Seals for control valve 02 complete	
7376014	Afdichtingsset voor 3 cilinders (CF500SL - SL-2 & SLC) - deze set bestaat uit: Afdichtingset	Seal set for 3 cylinders (CF500SL, SL-2 & SLC), this set consist of: 3 x seals for cylinder	
7398007	Hendel oog (besturingsventiel 02)	Control handle eye (control valve 02)	
7398008	Koker met S-arretering (besturingsventiel 02)	Tube with S-detent (control valve 02)	
7677004	Bedienplunjer L.= 195 mm. / D.= 25 mm. compleet	Operation plunger L.= 195 mm [7.68"] / D.= 25 mm [0.98"] complete	
8370042	Besturingsventiel 02 B-bediend (compleet)	Control valve 02 B-operation (complete)	
8370045	Besturingsventiel 02 A-bediend (compleet)	Control valve 02 A-operation (complete)	
501212.2	Veerring M12 - Elvz (8.8)	Spring washer M12 (8.8)	
503812100.2	Zeskantbout M12x100	Hexagon bolt M12x100	
70043/420	Rechte inschroefkoppeling 3/4" x 20 mm.	Straight screw-in coupling 3/4" x 20 mm [0.79"]	
70171.4	Minimess plug (0-225 Bar)	Minimess plug (0-225 Bar) [3263 PSI]	
70173/4.1	Kraagplug 3/4 (hol)	Plug 3/4 for valve spring (hollow)	
70183/4.1	Bonded seal 3/4" (afgedraaid)	Bonded seal 3/4 (machined)	
7154011.1	Zegeldop voor DB ventiel (rood) – spare part	Seal cap for pressure safety valve (red) - spare part	
7154011.1	Zegeldop voor DB ventiel (rood) – spare part	Seal cap for pressure safety valve (red) - spare part	
	<p>Wijzigingen voorbehouden. Geldigheid prijslijst gedurende het aangegeven kalenderjaar, waarbij altijd de actuele prijs in het Cargo Floor B.V. computersysteem geldt, het is raadzaam vooraf de actuele prijs bij Cargo Floor B.V. te checken</p> <p>Prijzen: Bruto per stuk in EURO, excl. B.T.W.</p> <p>Levering: af werk, volgens onze standaard leverings- en betalingsvoorwaarden</p> <p>Betaling: netto, binnen 14 dagen na factuurdatum</p> <p style="text-align: right;">Wijzigingen voorbehouden.</p>	<p>All changes reserved. This pricelist is valid during the given calendar year, valid is always the latest price given by the Cargo Floor computer system, so we advice you to contact us beforehand to check the price.</p> <p>Prices: Gross each in EURO, excl. VAT</p> <p>Delivery: Ex Works, according to our standard terms of payment and delivery</p> <p>Payment: nett, due 14 days from date of invoice</p> <p style="text-align: right;">All changes reserved</p>	
www.cargofloor.com - info@cargofloor.com - 0031-524593900			